



## Operating instructions

(ID-No. 00035110)

Stud feeder

Feederboy FB-9, FB-10

assembled:

00100090 FB-9

Date: \_\_\_\_\_

00100091 FB-10

Name: \_\_\_\_\_

## Table of contents

Table of contents .....	2
1 Preface and general information .....	3
1.1 General .....	3
1.2 Scope of supply .....	3
1.3 Intended use .....	3
1.4 Liability .....	4
1.5 Warranty .....	4
2 Safety information .....	5
2.1 Personnel responsible for safety .....	5
2.1.1 Operator .....	5
2.1.2 Qualified personnel .....	5
2.2 General safety instructions .....	6
2.3 Layout of the safety instructions .....	6
3 Technical Data .....	7
3.1 Models .....	7
3.2 Stud types .....	7
3.3 Dimensions and weight .....	7
3.4 Noise emission .....	7
3.5 Ambient conditions .....	7
4 Commissioning .....	8
4.1 Installation .....	8
5 Operation of Stud feeder .....	8
5.1 Loading of studs .....	8
5.2 Feeding of studs .....	9
6 Faults and troubleshooting .....	9
7 Lubrication and maintenance .....	10
8 Spare and wear parts .....	10
8.1 Requirements .....	10
8.2 Handling of orders .....	10
8.3 Explanatory notes on the spare part list .....	10
8.4 Exploded view FB-9, FB-10 .....	11
8.5 Spare part list FB-9, FB-10 .....	11
9 Appendix .....	12
9.1 Copyright .....	12
9.2 Manufacturer and contact person .....	12

# 1 Preface and general information

## 1.1 General

These operating instructions are destined for safe operation of the stud feeders type Feederboy FB-9 and FB-10. The safety instructions included hereinafter have to be observed.

The operating instructions must be available to anybody who is working with the stud feeder and the included instructions must be carefully attended to.

The operating instructions must always be complete and perfectly readable.

## 1.2 Scope of supply

The delivery normally consists of stud feeder and the operating instructions. The exact scope of supply is specified in the relevant accompanying documents.

These documents must be checked for conformity with the goods immediately after receipt of the delivery. OKU GmbH does not assume any guarantee for defects complained about belatedly.

Therefore,

- contact the forwarder immediately to complain about visible transport damages,
- contact OKU GmbH immediately to complain about visible defects and/or incompleteness of delivery.

## 1.3 Intended use

The stud feeder may only be used for feeding of single-flange studs to OKU stud guns.

**Any other use shall be deemed to be inappropriate!**

## 1.4 Liability

The information, data and notes of these operating instructions were up-to-date when passing for press. The specifications, illustrations and descriptions included hereinafter do not apply to any previously supplied stud feeders.

We do not assume liability for damages and operating troubles caused by:

- inappropriate use,
- unauthorised modification of the stud feeder,
- improper operation of the stud feeder,
- operating errors,
- disregard of these operating instructions.

## 1.5 Warranty

Conditions of warranty: see Standard Terms and Conditions of OKU GmbH.

Assert warranty claims against OKU GmbH immediately after detection of the defect or fault.

Warranty claims expire in those cases where liability claims cannot be made either.

## 2 Safety information

### 2.1 Personnel responsible for safety

#### 2.1.1 Operator

Operator is called any natural or juridical person who is using the stud feeder or on behalf of whom the stud feeder is used.

The operator and/or his safety officer must ensure that

- all essential regulations, instructions and laws will be observed,
- only qualified personnel will be working with the stud feeder,
- this personnel will have the operating instructions available at any time,
- unqualified personnel will be prohibited from working with the stud feeder.

#### 2.1.2 Qualified personnel

As qualified personnel are to be considered persons who were authorised by the safety officer of the plant to perform the necessary activities and who are able to recognise and avoid potential hazards because of their education, experience, instructions and their knowledge about corresponding standards and rules for the prevention of accidents as well as of the operating conditions (see IEC 364, Definition for qualified personnel).

## 2.2 General safety instructions

These safety instructions do not claim to be exhaustive. In case of any questions please contact OKU.

At the time of delivery the stud feeder is state of the art and regarded as reliable.

The stud feeder is a source of danger for persons, for the stud feeder itself and for other material assets of the operator if

- it is operated by unqualified personnel,
- it is used inappropriately.

Operate the stud feeder only when it is in perfect condition.

Any upgrade, modification or redesign of the stud feeder is basically prohibited. In this case please always confer with OKU.

## 2.3 Layout of the safety instructions

The safety instructions described hereinafter are arranged consistently.

### Warning about material damage

Pictogram	Meaning	Signal words	Guideline
	Warning about material damages	<b>Stop!</b>	Warns of <b>potential material damages</b> Consequences if disregarded: Damage to the stud feeder or its environment.

### Other information

Pictogram	Meaning	Signal words	Guideline
	General tip	<b>Tip!</b>	Marks a general useful tip. Adherence thereto will ease the use of the stud feeder.

## 3 Technical Data

### 3.1 Models

Model	Id. No.	Exclusively to be used with OKU stud guns type:
FB-9	00100090	AS-8, AS-9, EP-8, EP-9
FB-10	00100091	EP-10

### 3.2 Stud types

The stud feeder is suitable for feeding of single-flange studs in correct position.

Model	Stud types to be handled
FB-9	head dia. 8-9 mm
FB-10	head dia. 10 mm

### 3.3 Dimensions and weight

Length	approx. 72 mm
Diameter	approx. 110 mm
Weight	approx. 0,13 kg

### 3.4 Noise emission

The sound pressure level reaches up to 65 dB(A).

### 3.5 Ambient conditions

Use the stud feeder only in closed dry rooms.

The permissible ambient temperature during operation is from 10 °C to 40 °C.

## 4 Commissioning

Safety measures to be taken before starting to work with the stud feeder:

- check stud feeder for perfect condition,
- never operate a damaged stud feeder.

### 4.1 Installation

Place the stud feeder onto the feeding tube of the stud gun as shown in the picture and secure with the hose clamp.

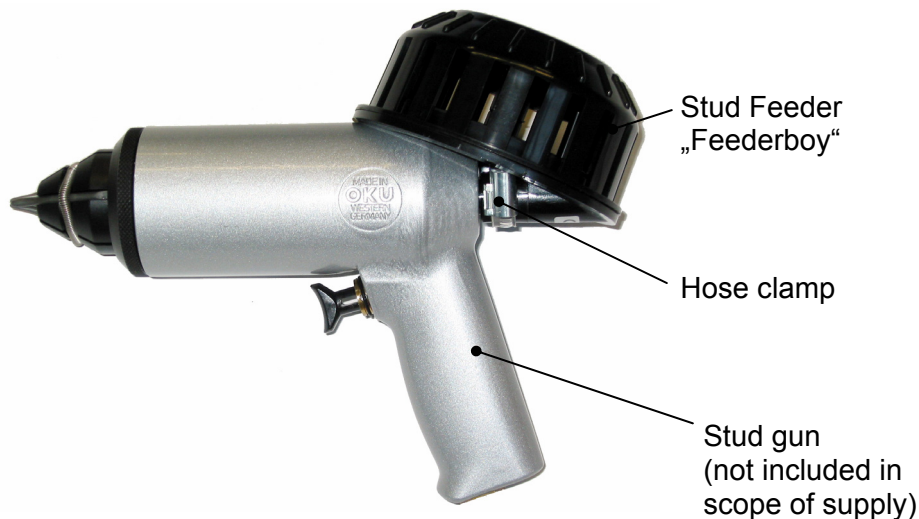

Illustration with stud gun AS-8

## 5 Operation of Stud feeder

### 5.1 Loading of studs

- Push the spring (3) out of the annular groove of the axle (4) until the feed wheel (5) can be removed from the axle.
- Load the feed wheel with approx. 50-100 studs.
- The stud gun has to be slightly inclined and the feed wheel placed onto the axle.



- Push the feed wheel in direction of the base plate (6) and engage the spring in the annular groove of the axle.

## 5.2 Feeding of studs

- Hold the gun vertically downwards.
- Keep turning the feed wheel slowly by hand half a rotation to the right and to the left until it has been filled with studs.



## 6 Faults and troubleshooting

Fault	Troubleshooting
Deformed or dirty stud jammed in the feeding tube of the stud gun	Take off feed wheel as described under 5.1 and remove the jammed stud.

## 7 Lubrication and maintenance

Clean stud feeder at regular intervals. For the rest the stud feeder is maintenance free.

## 8 Spare and wear parts

### 8.1 Requirements



**Stop!**

**Spare and wear parts must be in accordance with the technical requirements stipulated by the manufacturer.**

### 8.2 Handling of orders

To ensure punctual handling of orders please always state in your spare part orders the **OKU id.No.** of the required spare part. You will find the **OKU id.No.** in the exploded views and the spare part lists.

### 8.3 Explanatory notes on the spare part list

The item number of the required part in the spare part list corresponds to the number of the item in the exploded view.

## 8.4 Exploded view FB-9, FB-10

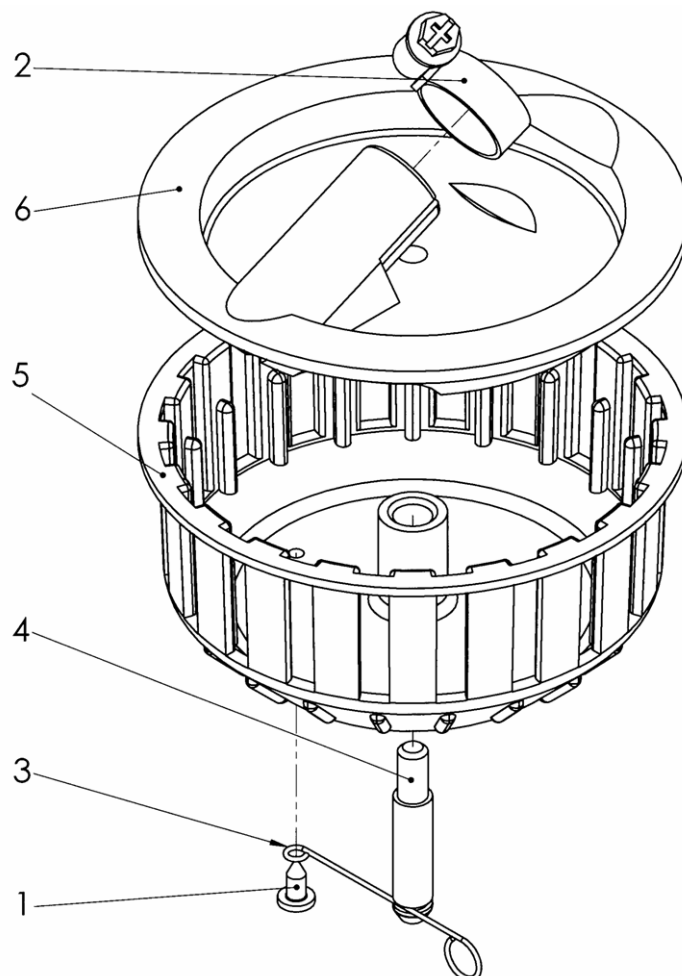

## 8.5 Spare part list FB-9, FB-10

Item	OKU id.No.	Number	Designation
1	00004094	1	Self-tapping fillister head screw
2	00004129	1	Hose clamp
3	00350889	1	Spring
4	00350890	1	Axle
5	00570105	1	Feed wheel
6	00570111	1	Base plate FB-9
	00570112	1	Base plate FB-10

## 9 Appendix

### 9.1 Copyright

© 09/2008

This documentation is protected by copyright which covers the exclusive rights to reproduce and distribute the documentation, as well as all translation rights. No material published in this documentation must be reproduced photographically or stored on microfilm, in electronic data bases, video disks, etc. Technical modifications reserved.

### 9.2 Manufacturer and contact person



OKU GmbH  
Assembly and Feeding Systems  
Rosenstraße 15  
73650 WINTERBACH  
GERMANY

Postfach 11 20  
73643 WINTERBACH  
GERMANY

Phone: +49 7181 707-0  
Fax: +49 7181 707-170  
Internet: <http://www.oku.de>

#### Your contact person is:

Sales Department Studs	Phone:	+49 7181 707-0
	Fax:	+49 7181 707-170
	E-Mail:	<a href="mailto:spikes@oku.de">spikes@oku.de</a>

# Representant för OKU i Sverige



Inprotec Automation AB  
Flöjelbergsgatan 8B  
431 37 Mölndal

Telefon: 031-761 67 00  
[www.inprotec.se](http://www.inprotec.se)

Kontaktpersoner försäljning och reservdelar

Peter Fellsner  
Telefon: 031-761 01 10  
Mobil: 0707- 80 28 40

John Carlson  
Telefon: 031-761 01 20  
Mobil: 0707- 80 28 20